

YACHT HULL DATA REQUIRED FOR DIMENSIONING OF SPARS AND STANDING RIGGING

IDENTIFICATION

RigData No. (optional):

Yacht / Model:

End customer (optional):

Dealer / Yard:

CRAFT DATA

Craft type: Catamaran / Trimaran

Length overall: mm

Max beam: mm

C-C Hulls: mm

Displacement: kg

Displacement based on:
 Empty yacht / Equipped yacht

Catamaran only
Windward hull to be flown above the water: Yes / No

Trimaran only
Outer pontoon volume: litres

DOC ID: 5C75-765A

Print date: 2024-12-17

COMMENTS REGARDING CRAFT OR RIGHTING MOMENT

RIG SETUP

1. Double diamonds with lower shrouds

2. Double diamonds no lower shrouds, forward struts needed

3. Single diamond with lower shrouds,

4. Single diamond no lower shrouds, forward strut may be needed,

Other:

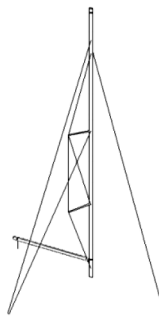
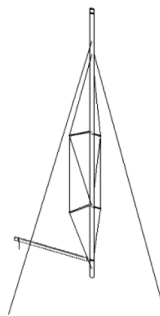
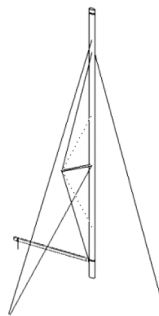
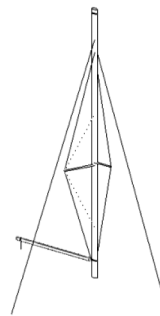
1
2
3
4

Please transfer data into Seldén's online rigfact form.

DRAFT COPY

Signature BLOCK LETTERS Date



INFORMATION REQUIRED FOR DIMENSIONING OF SPARS AND STANDING RIGGING

Craft / Model:

RIG OPTIONS

- Conventional mast, Furling mast, Carbon mast

- Tapered mast

- Standard roach, Medium roach,
- Square roach



RIG MEASURES

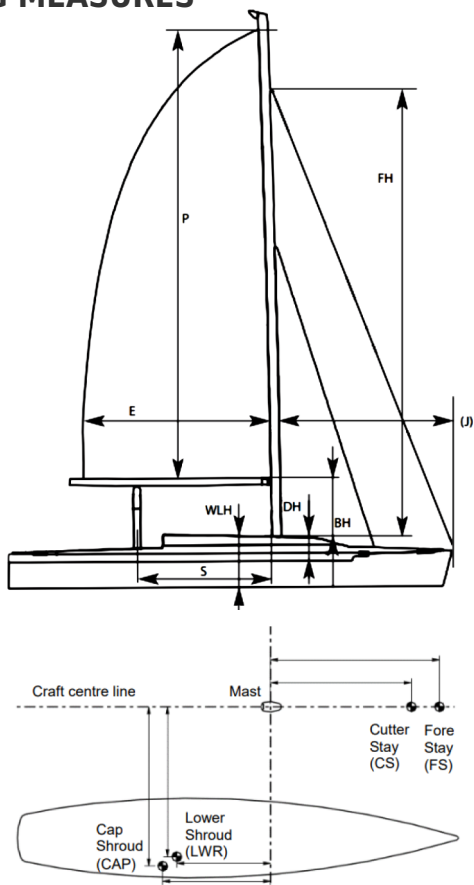

Forestay height	FH	<input style="width: 40px;" type="text"/>	mm
Cutterstay height (optional)	CSH	<input style="width: 40px;" type="text"/>	mm
Main sail luff length	P	<input style="width: 40px;" type="text"/>	mm
Boom height (top of boom)	BH	<input style="width: 40px;" type="text"/>	mm
Main sail foot length	E	<input style="width: 40px;" type="text"/>	mm
Main sheet hull attachment from aft face of mast	S	<input style="width: 40px;" type="text"/>	mm
Coach roof height above cap-chainplate	DH	<input style="width: 40px;" type="text"/>	mm
Deck intersection height above waterline	WLH	<input style="width: 40px;" type="text"/>	mm

	<i>Lat.</i>	<i>Long.</i>	
Cap	<input style="width: 40px;" type="text"/>	<input style="width: 40px;" type="text"/>	mm
LWR	<input style="width: 40px;" type="text"/>	<input style="width: 40px;" type="text"/>	mm
FS	<input style="width: 40px;" type="text"/>	<input style="width: 40px;" type="text"/>	mm
CS	<input style="width: 40px;" type="text"/>	<input style="width: 40px;" type="text"/>	mm
<i>* Cap shroud bridle chainplates</i>			
Forw.	<input style="width: 40px;" type="text"/>	<input style="width: 40px;" type="text"/>	mm
Aft	<input style="width: 40px;" type="text"/>	<input style="width: 40px;" type="text"/>	mm

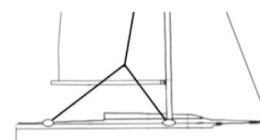

** If cap shroud bridle is to be used, please state bridle chainplate positions*

OTHER RIGGING PARTICULARS

Please transfer data into Seldén's online rigfact form.

DRAFT COPY

Signature

BLOCK LETTERS

Date



Print date: 2024-12-17 DOC ID: 5C75-765A