

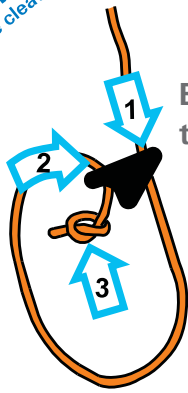

Line-Lok® instructions CL271 & CL276

The world's best guy runner. Locks lines securely. Will not slip.



Easy to rig



Push up to tension and secure



Pull lines apart to release

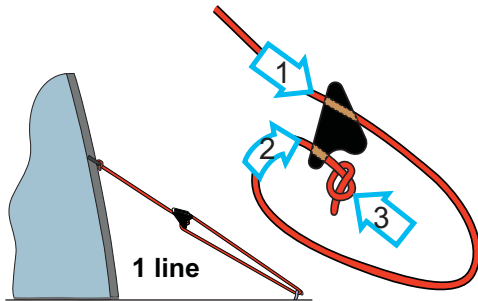
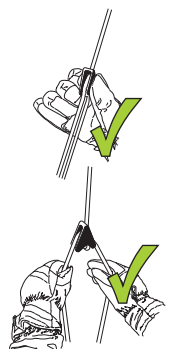
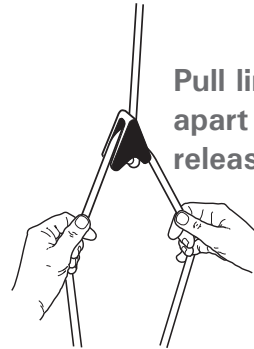

1 line

CL276 3 - 6 mm (1/8" - 1/4") Ø
CL271 4 - 8 mm (5/32" - 5/16") Ø

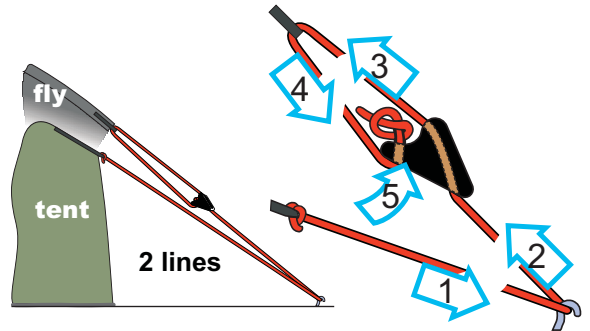

2 lines

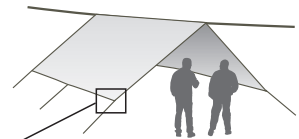
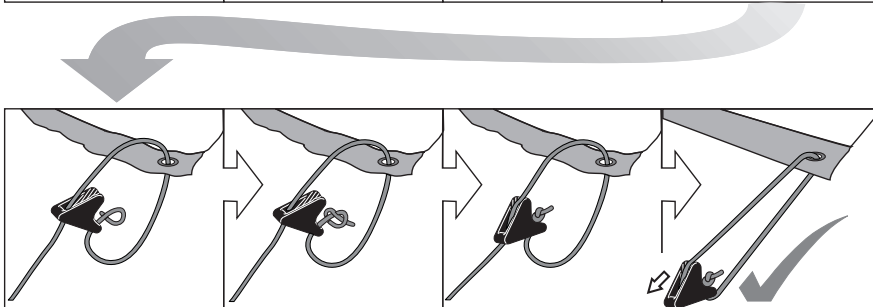
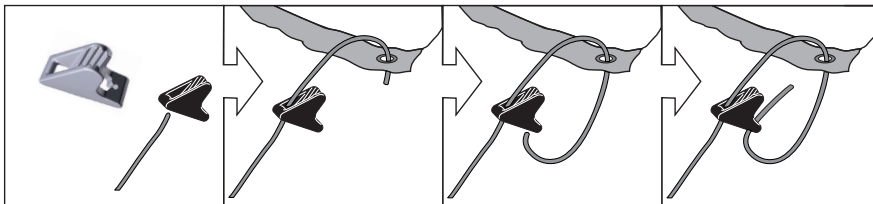

Rig like this for hammocks

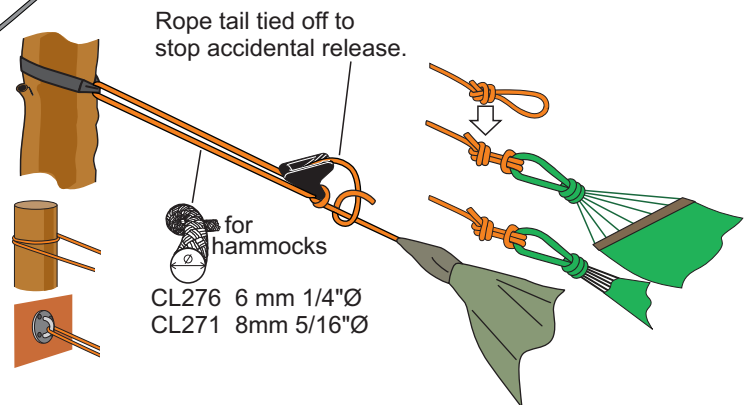

Rope tail tied off to stop accidental release.

for hammocks

CL276 6 mm 1/4"Ø
CL271 8mm 5/16"Ø

