

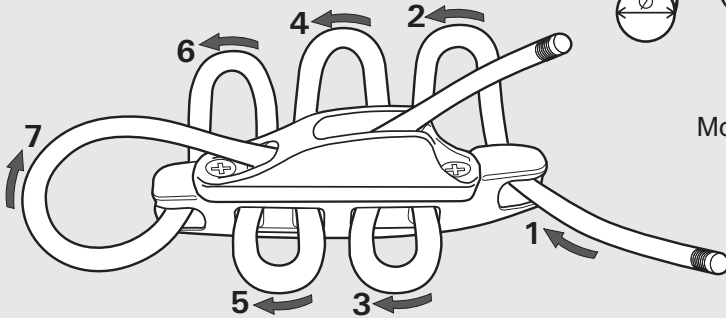

CL827-xx Aero cleat Instructions

Compact cleats that are rigged on a rope. Nylon and alloy versions.
 Easy to rig and adjust. Strong and wear resistant.
 Ideal for forestay tensioning, kitesurfing, sports netting, sun sails, canvas structures, tie-downs, radio masts and aerials.

Standard rigging for all cleats
2:1 advantage



4 - 6mm
 (5/32" - 1/4") Ø



Move cleat along the rope by hand. No tools required.

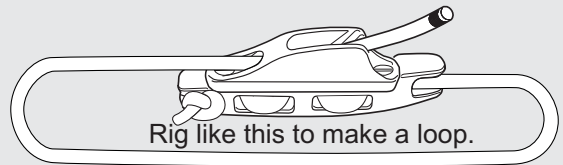

When using 4mm rope, take an extra turn round centre pillar.

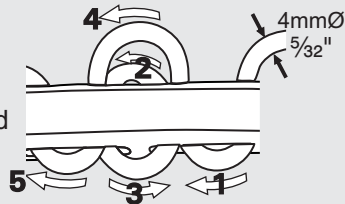

Rigging like this = no rope tail.

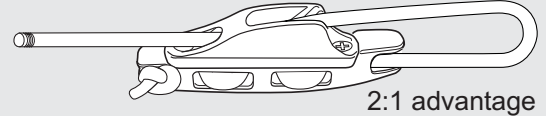

CL827-03 (CL827 Aero base with black nylon CL203)  43gm.
 1.5oz.

CL827-11 (CL827 Aero base with alloy CL211 Mk1 silver)

CL827-11AN (CL827 Aero base with alloy CL211 Mk1 hard anodised)  62gm.
 2.2oz.

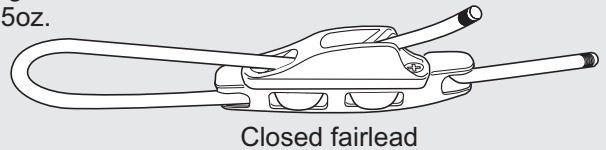

CL827-17 (CL827 Aero base with alloy CL217 Mk1 silver)  59gm.
 2.1oz.

CL827-17AN (CL827 Aero base with alloy CL217 Mk1 hard anodised)

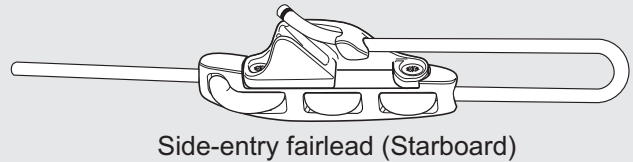

CL827-18 (CL827 Aero base with alloy CL218 Mk1 silver)  59gm.
 2.1oz.

CL827-18AN (CL827 Aero base with alloy CL218 Mk1 hard anodised)



CL827-36 (CL827 Aero base with alloy CL236 silver)

CL827-36AN (CL827 Aero base with alloy CL236 hard anodised)

 69gm.
 2.4oz.

